

PPP: MAILDROP LIST & PLACEMENT OF POSTERS

PROJECT: PELLA HOUSING	AREA: PELLA, NORTHERN CAPE
ADDRESS PELLA ROAD, PELLA, NORTHERN CAPE	
CONTACT PERSON EMILE ESQUIRE	
DATE: 14/03/2019	DONE BY: BERNARD DE WITT

POSTERS

	ADDRESS	DESCRIPTIVE NOTES
1	A2 POSTER - On site	
2	A2 POSTER - N14 / PELLA TURN-OFF	
3	A3 POSTER - Kai-Ma MUNICIPALITY (POFADDER)	

MAILDROP

	ADDRESS: Street no. & name	DESCRIPTIVE NOTES (Owner details, property description ect.)
1	A3 POSTER - Kai-Ma Municipality - Pella	
2	A3 POSTER - Aggenbag Supermark.	
3	A3 POSTER - Sunmoon Shop - close to the site.	
4	Maildrops done at all houses in Duine Street +	
5	informal dwellings on the property.	
6	Maildrops done along Pella Road; east of the site.	
7	Maildrops given to Antoncia Losper - House on the property.	
8	Maildrops given to Jo-Ann Biergaard - House on the property.	
9	Maildrops given to Amanda (Ward Councillor). - Cell: 071 757 8768	
10	Maildrops given to admin at Pella Municipal Office - 054 971 0062	
11		
12		
13		
14		

MAILDROPS AND POSTER PLACEMENT: PROPOSED HOUSING DEVELOPMENT ON REMAINDER OF ERF 1077, LOCATED BETWEEN SWARTKOPPIES STREET AND PELLA ROAD, PELLA, KHAI-MA LOCAL MUNICIPALITY – 14 MARCH 2019.



Figure 1: A2 Poster placed against the fence on site as viewed from the corner of Pella Road and Duine Street, looking in a western direction.



Figure 2: A2 Poster placed against the fence on site as viewed from the corner of Pella Road and Duine Street, looking in a south-western direction. Informal structures can be seen on site.



Figure 3: A2 Poster placed against the fence on site as viewed from the corner of Pella Road and Duine Street, looking in a south-western direction. Informal structures can be seen on site.

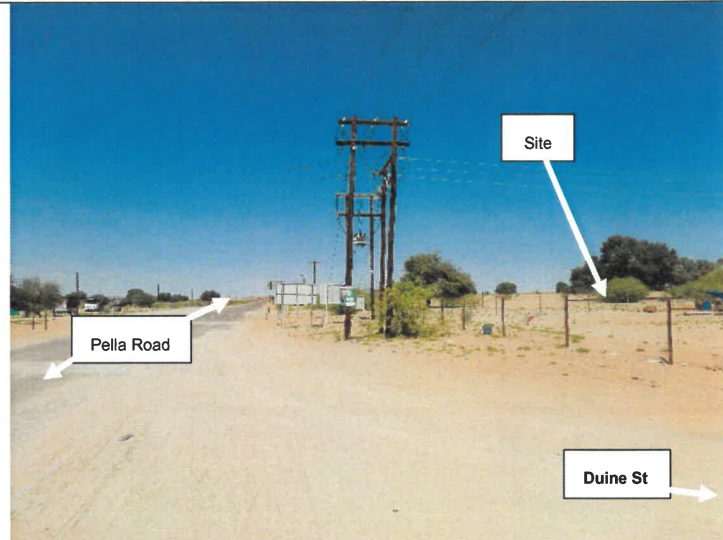

Figure 4: A2 Poster placed against the fence on site as viewed from the corner of Pella Road and Duine Street, looking in a southern direction. Informal structures can be seen on site.



Figure 5: A2 Poster placed against the fence on site as viewed from the corner of Pella Road and Duine Street, looking in a south-western direction. Informal structures can be seen on site.



Figure 6: A2 Poster placed against the fence on site as viewed from the corner of Pella Road and Duine Street, looking in north-western direction. Informal structures can be seen on site.



Figure 7: A2 Poster placed against the fence on site as viewed from the corner of Pella Road and Duine Street, looking in a south-western direction. Informal structures can be seen on site.



Figure 8: A3 Poster placed against notice board at Khai-Ma Municipality in Pella.

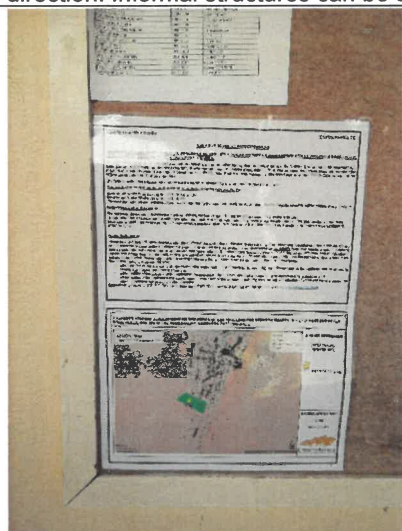

Figure 9: A3 Poster placed against notice board at Khai-Ma Municipality in Pella.



Figure 10: A3 Poster placed against notice board at Khai-Ma Municipality in Pella.



Figure 11: A3 Poster placed against notice board at Khai-Ma Municipality in Pella.



Figure 12: A3 Poster placed against notice board at Agenbag Supermarket.



Figure 13: A3 Poster placed against notice board at Agenbag Supermarket.



Figure 14: A3 Poster placed against notice board at Agenbag Supermarket.



Figure 15: A3 poster attached to the door of Sunmoon Groceries Shop in Pella.



Figure 16: A3 poster attached to the door of Sunmoon Groceries Shop in Pella.



Figure 17: A3 poster attached to the door of Sunmoon Groceries Shop in Pella.

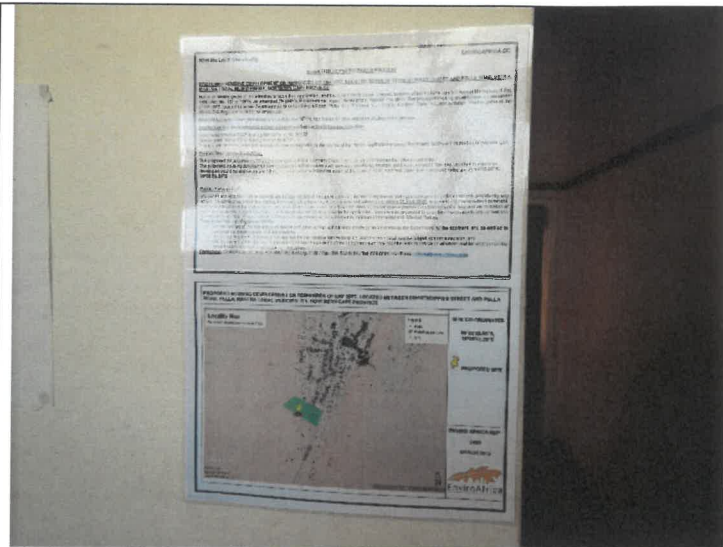

Figure 18: Maildrops done along Kerk Street.



Figure 19: A3 Poster placed against wall inside Khai-Ma Municipal office in Pella.



Figure 20: A3 Poster placed against wall inside Khai-Ma Municipality office in Pella.



Figure 21: Maildrops done on site.



Figure 22: Maildrops done along Duine Street.



Figure 23: A2 Poster placed against fence along intersection of N14 and Pella Road.

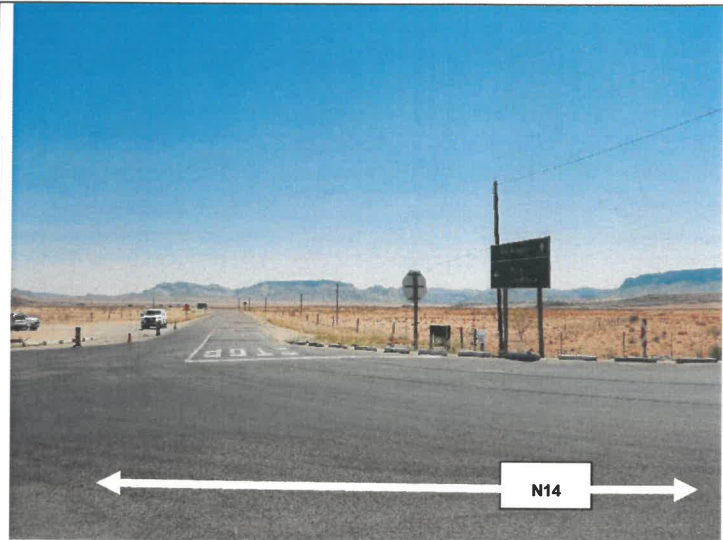

Figure 24: A2 Poster placed against fence along intersection of N14 and Pella Road. Looking north, towards Pella Road.