

 SAREL BESTER Raadgewende Siviele Ingenieurs Argitekturendienste Datum: 26/06/2016 MC BESTER Pr. Ing. B. Ing. LSA61570208, LSA6APT1218 Posbus 21, CERES, 6835 Tel. 023-312 2017 * Faks. 086-514 3350 e-pos: admin@sari.co.za		KOPIEREG VOORBEHOU - 2017 A4	
		KLIËNT: Mnr. J. Faul Pobus CERES 6835	PROJEK: NUWE DAM ONDERSOEK, CERES
DETAIL: Kontoerplan met waluitleg		GETEKEN: SC Hartzenberg	TEK. NO. 1804-S1-01

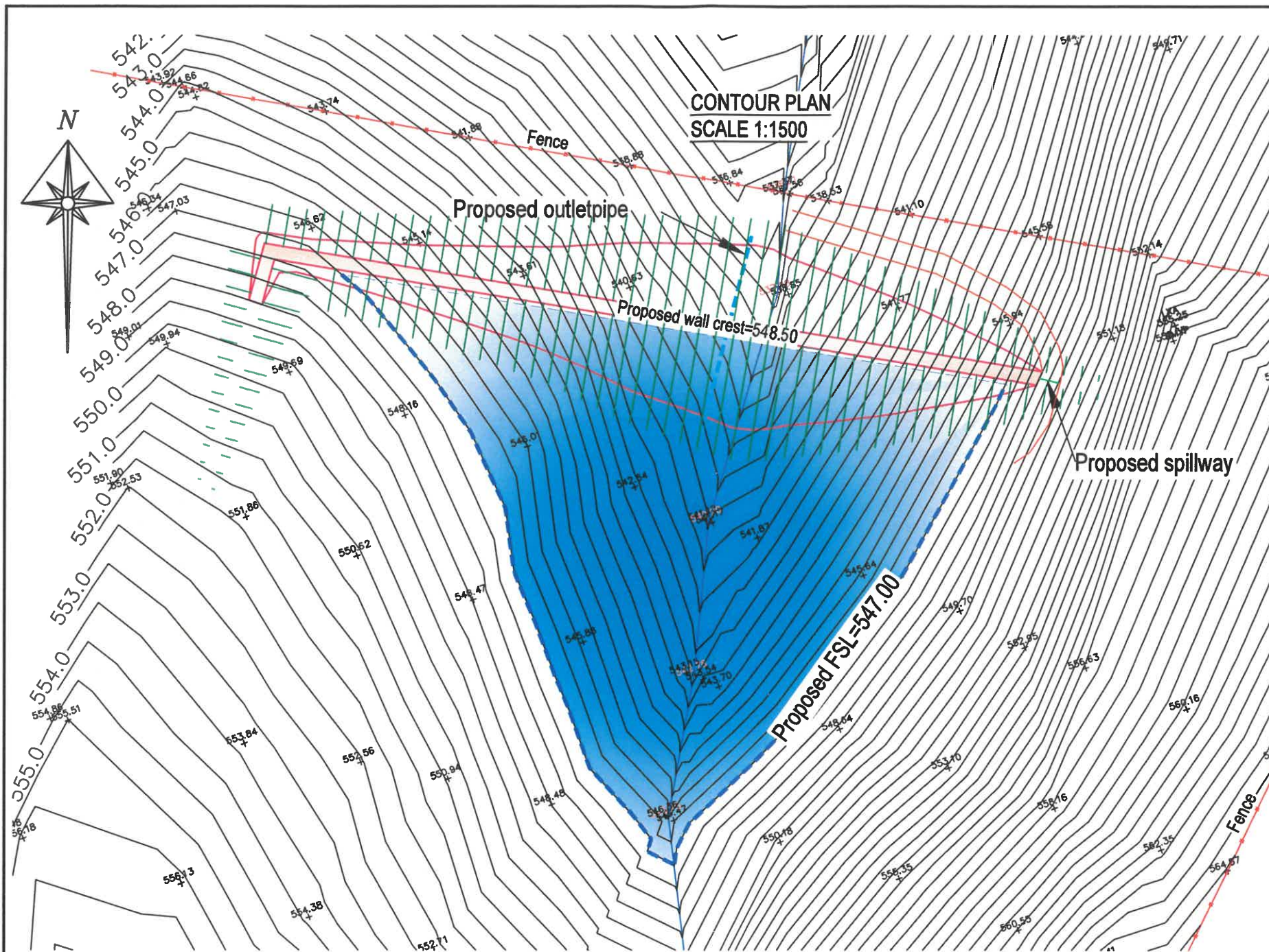

TECHNICAL DATA: NEW DAM	
Wall crest width (m)	4.00
Wall crest level (msl)	548.50
Lowest groundlevel D/S (msl)	537.40
Maximum wall height (m)	11.10
Wall crest length (m)	237.00
Upstream slope	1: 3.00
Downstream slope	1: 2.00
Earthfill -cut-off trench excluded (m³)	23 400
Total earthfill (m³)	29 100
Full supply level (msl)	547.00
Total freeboard (m)	1.50
Netto storage capacity (m³)	67 600
Flooded area (ha)	1.70
Dam footprint area (ha)	2.00

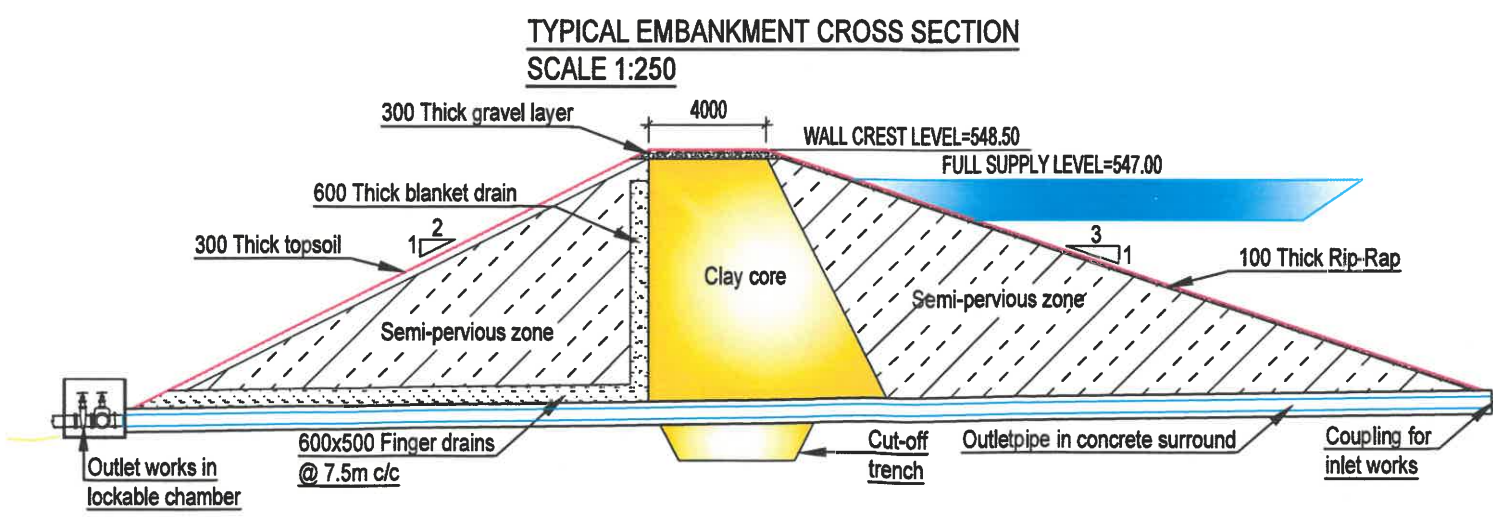
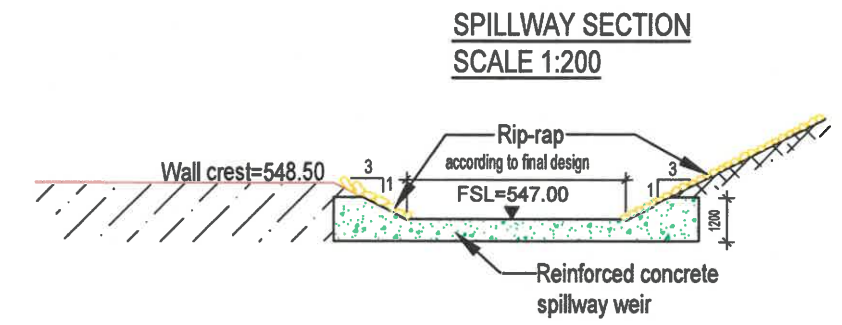

CLIENT: Jade Farming P.O. Box 72 CERES 6835		 SAREL BESTER ENGINEERS Consulting Civil Engineers Architectural Service	
PROJECT: NEW DAM INVESTIGATION AT JADE HILLS, CERES		Date: 26/11/2018 MC BESTER Pt. Eng., B.Eng., MBA/CE/70598, SACAPT/1218 P.O. Box 21, CERES, 6835 Ph: 025-312 2017 * Fax 086-514 3350 e-mail: admin@sari.co.za	
DRAWN SC Hartzenberg	DATE FEB. 2018	SCALE soos getoon	SHEET 1 van 1
DETAIL: Contour, Embankment & Spillway: Construction Sections	SURVEYED SC Hartzenberg	DESIGNED Sarel Bester Ingenieurs	DWG. NR. 1804-S2-01 REV. A3
COPYRIGHT RESERVED - 2018			A3