

From: Mandri Viljoen <planning1@rumboll.co.za>
Sent: Tuesday, 01 October 2024 08:27
To: environment@caa.co.za; MashiloaneN@caa.co.za
Subject: FW: PRO FORMA INVOICE - CK RUMBOL & PARTNERS (OBSTACLES APPROVAL APPLICATION_De Hoop 132Kv Powerline CAA_2024_2_200)
Attachments: MBURY 132kv LILO R1a.kmz; Schoonspruit 132kv LILO Line Staking Table R1a.pdf; Malmesbury 132kv LILO Line Profile R1b.pdf; Cover Letter_30.09.2024.pdf

Good Day

Please find attached a cover letter and supporting documentation for our obstacles approval application, reference number CAA_2024_2_200, for your review.

Kindly confirm receipt.

Regards,



CK RUMBOLL
& PARTNERS

Mandri Crafford
Professional Town Planner
Reg. No.: (A/3241/2022)

16 Rainer Street, Malmesbury,
Western Cape, 7299
022 482 1845
planning1@rumboll.co.za
www.ckrumboll.co.za

From: Mandri Viljoen <planning1@rumboll.co.za>
Sent: Monday, 30 September 2024 16:24
To: 'Obstacles@caa.co.za' <Obstacles@caa.co.za>
Cc: 'Lizell Stroh' <StrohL@caa.co.za>; 'Canny Mosebjadi Mothapo' <MothapoC@caa.co.za>; 'Doris Khoza' <KhozaD@caa.co.za>; 'Simpfiwe Masilela' <Masilelas@caa.co.za>
Subject: RE: PRO FORMA INVOICE - CK RUMBOL & PARTNERS (OBSTACLES APPROVAL APPLICATION_De Hoop 132Kv Powerline CAA_2024_2_200)

Good Day

Please find attached a cover letter and supporting documentation for our obstacles approval application, reference number CAA_2024_2_200, for your review.

Kindly confirm receipt.

Regards,



CK RUMBOLL
& PARTNERS

Mandri Crafford
Professional Town Planner
Reg. No.: (A/3241/2022)

16 Rainer Street, Malmesbury,
Western Cape, 7299
022 482 1845
planning.1@rumboll.co.za
www.ckrumboll.co.za

From: Mandri Viljoen <planning1@rumboll.co.za>

Sent: Wednesday, 07 August 2024 10:32

To: 'Canny Mosebjadi Mothapo' <MoithapoC@caa.co.za>

Cc: 'StrohL@caa.co.za' <StrohL@caa.co.za>; 'Obstacles@caa.co.za' <Obstacles@caa.co.za>; 'KhozaD@caa.co.za' <KhozaD@caa.co.za>; 'Masilelas@caa.co.za' <Masilelas@caa.co.za>

Subject: RE: PRO FORMA INVOICE - CK RUMBOL & PARTNERS

Good Day

We require urgent feedback on the status of our application for obstacles approval (De Hoop 132Kv Powerline CAA_2024_2_200).

Regards,



CK RUMBOLL
& PARTNERS

Mandri Crafford
Professional Town Planner
Reg. No.: (A/3241/2022)

16 Rainer Street, Malmesbury,
Western Cape, 7299
022 482 1845
planning.1@rumboll.co.za
www.ckrumboll.co.za

From: Mandri Viljoen <planning1@rumboll.co.za>

Sent: Friday, 14 June 2024 15:20

To: 'Canny Mosebjadi Mothapo' <MoithapoC@caa.co.za>

Cc: 'StrohL@caa.co.za' <StrohL@caa.co.za>; 'Obstacles@caa.co.za' <Obstacles@caa.co.za>; 'KhozaD@caa.co.za' <KhozaD@caa.co.za>; 'Masilelas@caa.co.za' <Masilelas@caa.co.za>

Subject: RE: PRO FORMA INVOICE - CK RUMBOL & PARTNERS

Good Day

We require urgent feedback on the status of our application for obstacles approval (De Hoop 132Kv Powerline CAA_2024_2_200).

Regards,



CK RUMBOLL
& PARTNERS

Mandri Crafford
Professional Town Planner
Reg. No.: (A/3241/2022)

16 Rainer Street, Malmesbury,
Western Cape, 7299
022 482 1845
planning.1@rumboll.co.za
www.ckrumboll.co.za

From: Mandri Viljoen <planning1@rumboll.co.za>

Sent: Thursday, 23 May 2024 12:45

To: 'Canny Mosebjadi Mothapo' <MothapoC@caa.co.za>

Cc: 'StrohL@caa.co.za' <StrohL@caa.co.za>; 'Obstacles@caa.co.za' <Obstacles@caa.co.za>; 'KhozaD@caa.co.za' <KhozaD@caa.co.za>; 'Masilelas@caa.co.za' <Masilelas@caa.co.za>

Subject: RE: PRO FORMA INVOICE - CK RUMBOL & PARTNERS

Good Day

Please confirm the status of our application for obstacles approval (De Hoop 132Kv Powerline CAA_2024_2_200) after the proof of payment was submitted on 5 April 2024. We have not had any feedback.

Regards,



CK RUMBOLL
& PARTNERS

Mandri Crafford
Professional Town Planner
Reg. No.: (A/3241/2022)

16 Rainer Street, Malmesbury,
Western Cape, 7299
022 482 1845
planning.1@rumboll.co.za
www.ckrumboll.co.za

From: Mandri Viljoen <planning1@rumboll.co.za>

Sent: Monday, 06 May 2024 08:13

To: 'Canny Mosebjadi Mothapo' <MothapoC@caa.co.za>

Cc: 'StrohL@caa.co.za' <StrohL@caa.co.za>; 'Obstacles@caa.co.za' <Obstacles@caa.co.za>; 'KhozaD@caa.co.za' <KhozaD@caa.co.za>; 'Masilelas@caa.co.za' <Masilelas@caa.co.za>

Subject: RE: PRO FORMA INVOICE - CK RUMBOL & PARTNERS

Good Day

Herewith is a reminder of your response to my email sent below.

Regards,



CK RUMBOLL
& PARTNERS

Mandri Crafford
Professional Town Planner
Reg. No.: (A/3241/2022)

16 Rainer Street, Malmesbury,
Western Cape, 7299
022 482 1845
planning.1@rumboll.co.za
www.ckrumboll.co.za

From: Mandri Viljoen <planning1@rumboll.co.za>
Sent: Tuesday, 23 April 2024 10:52
To: 'Canny Mosebjadi Mothapo' <MoithapoC@caa.co.za>
Subject: RE: PRO FORMA INVOICE - CK RUMBOL & PARTNERS

Good Day

Could you kindly confirm the status of our application for obstacles approval (De Hoop 132Kv Powerline CAA_2024_2_200) after the proof of payment was submitted on 5 April 2024?

Regards,



CK RUMBOLL
& PARTNERS

Mandri Crafford
Professional Town Planner
Reg. No.: (A/3241/2022)

16 Rainer Street, Malmesbury,
Western Cape, 7299
022 482 1845
planning1@rumboll.co.za
www.ckrumboll.co.za

From: Mandri Viljoen <planning1@rumboll.co.za>
Sent: Friday, 05 April 2024 15:26
To: 'Canny Mosebjadi Mothapo' <MoithapoC@caa.co.za>
Subject: RE: PRO FORMA INVOICE - CK RUMBOL & PARTNERS

Good Day

Thank you for your email.

The Proof of Payment is attached.

Kind regards,

Mandri



CK RUMBOLL
& PARTNERS

Mandri Crafford
Professional Town Planner
Reg. No.: (A/3241/2022)

16 Rainer Street, Malmesbury,
Western Cape, 7299
022 482 1845
planning1@rumboll.co.za
www.ckrumboll.co.za

From: Canny Mosebjadi Mothapo <MoithapoC@caa.co.za>
Sent: Wednesday, 03 April 2024 23:19
To: planning1@rumboll.co.za
Subject: RE: PRO FORMA INVOICE - CK RUMBOL & PARTNERS

Good evening,

Kindly find attached the pro forma invoice for your attention, use the document number as reference for payment.

Regards

Canny Mosebjadi Mothapo

Data Coordinator

Aviation Infrastructure

Office: [0115451364](tel:0115451364) | **Email:** MothapoC@caa.co.za | www.caa.co.za

Follow us on:      Subscribe to: 



 SACAA  OfficialSACAA  officialsacaa  South African Civil Aviation Authority  www.caa.co.za

Report fraud and corruption: 0800 204 911 | sacaa@thehotline.co.za | SMS: 30916

This email has been scanned for email related threats and delivered safely by Mimecast.
For more information please visit <http://www.mimecast.com>

CK RUMBOLL & VENNOTE / PARTNERS



PROFFESIONELE LANDMETERS ~ ENGINEERING AND MINE SURVEYORS ~ STADS- EN STREEKSBEPLANNERS ~ SECTIONAL TITLE CONSULTANTS

30/09/2024

OUR REF: MAL/12747/MC

YOUR REF: CAA_2024_2_200

BY EMAIL: Obstacles <Obstacles@caa.co.za>; Lizell Stroh <StrohL@caa.co.za>; Canny Mosebjadi Mothapo <MothapoC@caa.co.za>; Doris Khoza <KhozaD@caa.co.za>; Simphiwe Masilela <Masilelas@caa.co.za>

ATTENTION: To whom this may concern

South African Civil Aviation Authority
Private Bag X 73
Halfway House
MIDRAND
1685

Mr./Ms.,

RE: UPDATED OBSTACLES APPROVAL APPLICATION FOR PROPOSED 132KV OVERHEAD POWERLINE OVER FARMS RE/1113, 18/766, 13/766, RE/8/766, 22/766, 24/766, RE/15/766, MALMESBURY REGISTRATION DIVISION, ERF 373 ABBOTSDALE, AND ERVEN 12081 & 12496, MALMESBURY

We hereby submit updated documentation in support of the obstacles approval application for the proposed 132kV overhead powerline in Swartland Municipality. Please find a summary of the correspondence and documents previously submitted, as well as the new amendments:

1. Initial Submission

An obstacles approval application was submitted via email on 14 February 2024. Ms. Lizell Stroh acknowledged receipt and referred the matter to Ms. Canny Mosebjadi Mothapo for further processing.

2. Pro-forma Invoice

On 3 April 2024, a pro-forma invoice (Document No: QT042487, for R1 070.00, Ref. No: CAA_2024_2_200) was received via email.

3. Proof of Payment

Proof of payment for the above invoice was submitted by email on 5 April 2024.

4. Amendments

Since the initial application, amendments to the line route have been made. Accordingly, we submit the

VENNOTE / PARTNERS:

IHJ Rumboll PrL (SA), BSc (Surv), M.I.P.L.S., AP Steyl PrL (SA), BSc (Surv), M.I.P.L.S.

ADDRESS / ADRES: reception@rumboll.co.za / PO Box 211 / Rainierstr 16, Malmesbury, 7299
MALMESBURY (T) 022 482 1845

following updated documents for your review:

- ❖ KMZ file reflecting the new route and structure positions
- ❖ Line profile
- ❖ Staking table detailing each structure

We kindly request that your department review and approve the updated application for the proposed powerline. Should you require any additional information, please do not hesitate to contact us.

Thank you for your attention to this matter.

Regards,



Mandri Crafford

For *CK RUMBOLL AND PARTNERS*

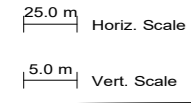
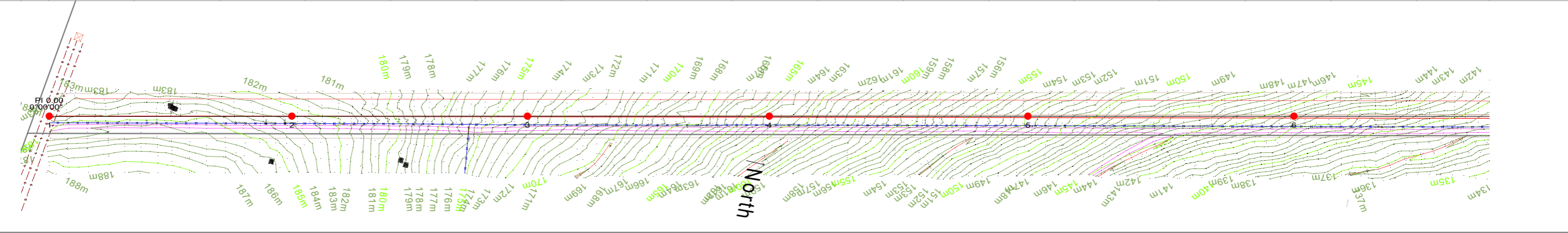
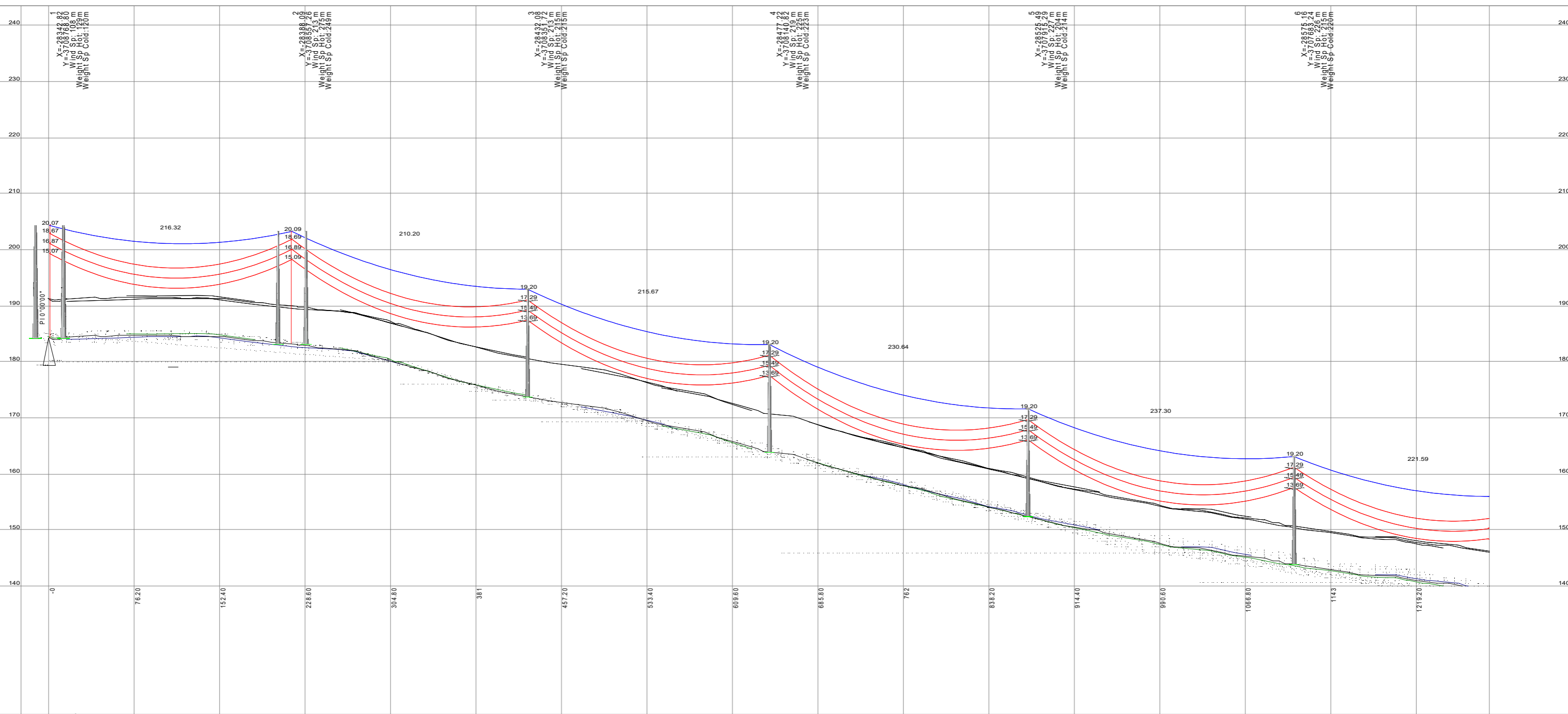

DESIGN CRITERIA

- Min Ground Clearance: 6.3m + 0.5m
- Min Road Clearance: 7.5m
- Min Kingbird Temp: -5 °C
- Max Kingbird Temp: 70°C
- Conductor ACSR Kingbird
- Cond Loading Criteria: C_1800 @ 15°C Final
- OPGW
- OPGW Loading Criteria: 12.0% UTS @ 15°C Final

Co Ordinate System:
WG19: South Africa Hartebeeshoek94

Design Criteria
Reliability Level 2

Consultant:
Lyners Consulting Engineers

Client:
ESKOM
Western Cape Region

CONTRACT
Swartland Municipality
Schoonspruit Substation
132kV Loop In / Out Overhead Line
Dassenburg - Malmesbury

TITLE
LINE PROFILE
Structure 1 to 6

| REV | DATE | DESCRIPTION | BY | CHKD | APPROVED | SHT | SCALE | DATE | DRG. No. | REV. |
|-----|---------|-----------------------|----|------|----------|-----|------------|---------|------------------|------|
| 01 | 08_2022 | Prelim Design for DRT | RG | TG | CHECKED | TG | See Scales | 11_2023 | 52 139 1826 | 01 |
| | | | | | | | 1 OF 6 | | Set 2 Sheet 1 A1 | |

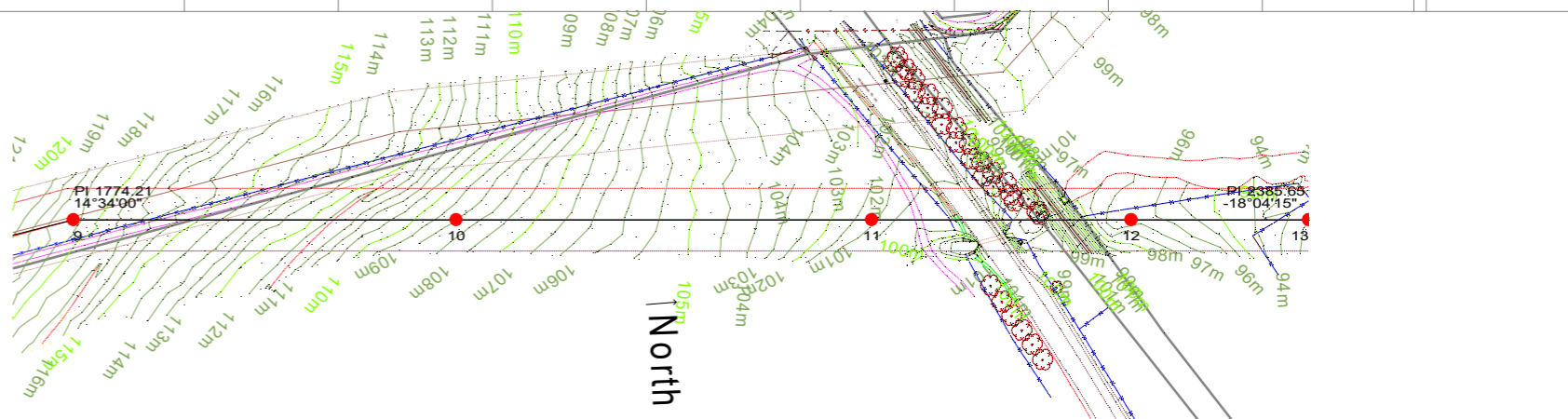
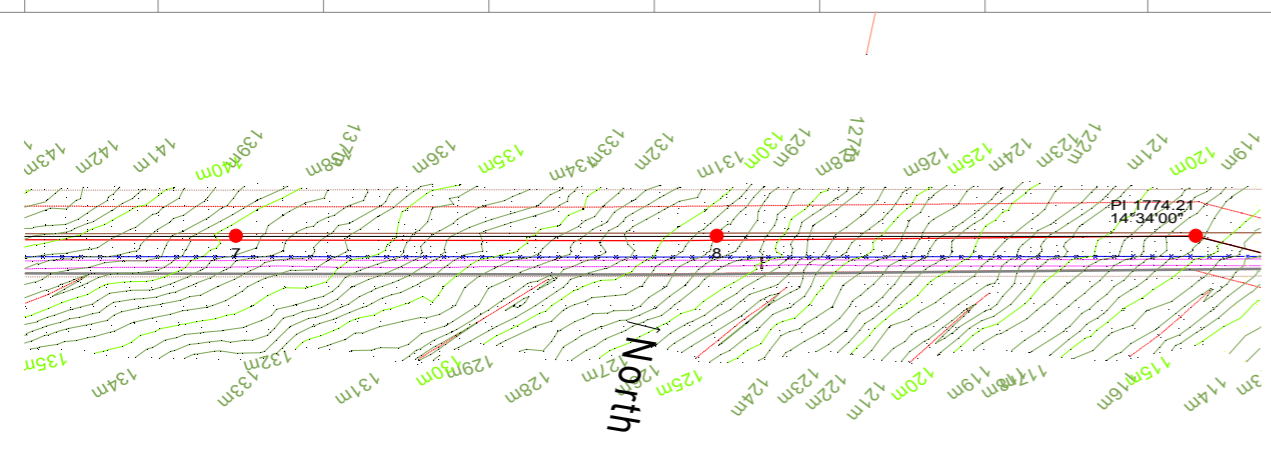
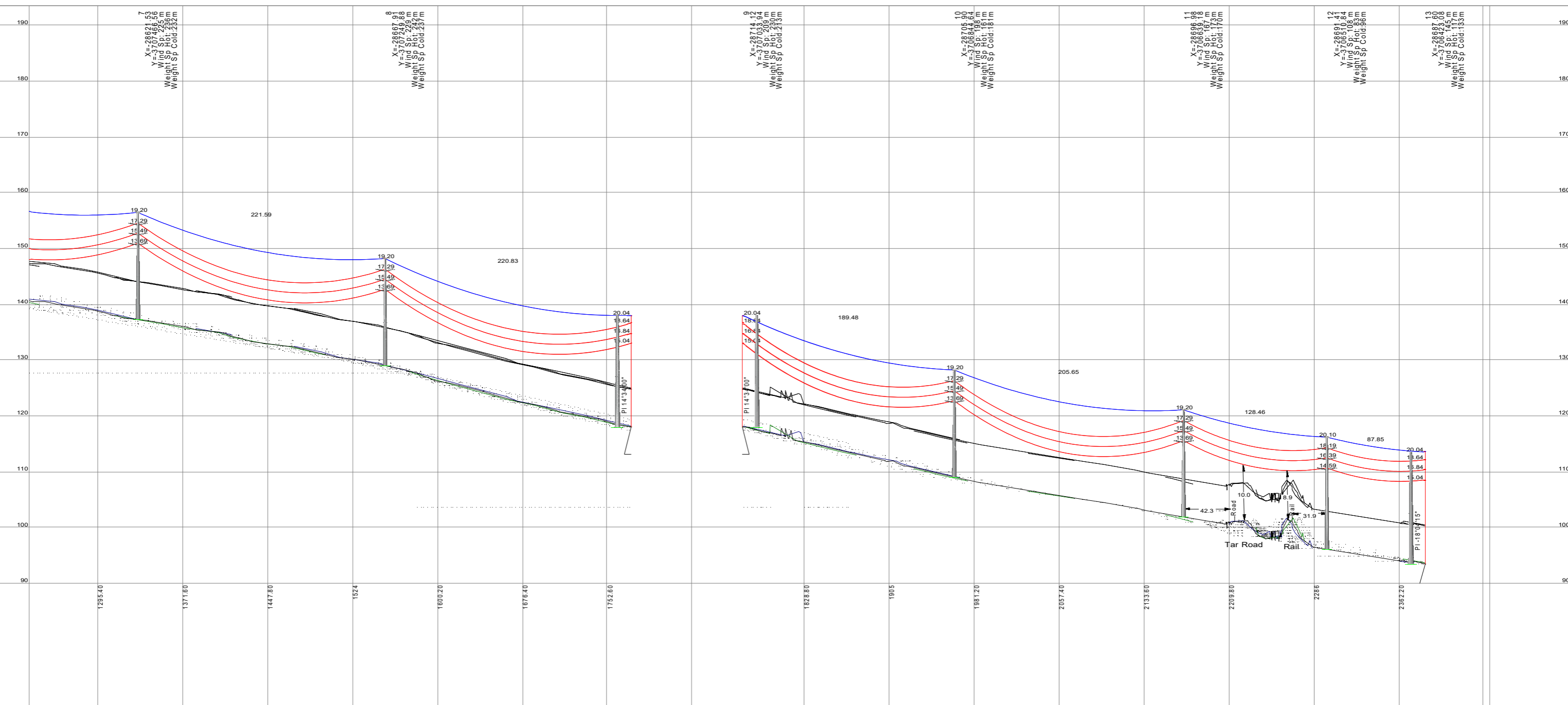

25.0 m Horiz. Scale
5.0 m Vert. Scale

DESIGN CRITERIA
 Min Ground Clearance: 6.3m + 0.5m
 Min Road Clearance: 7.5m
 Min Kingbird Temp: -5 °C
 Max Kingbird Temp: 70°C
 Conductor ACSR Kingbird
 Cond Loading Criteria: C_1800 @ 15°C Final
 OPGW
 OPGW Loading Criteria: 12.0% UTS @ 15°C Final

Co Ordinate System:
 WG19: South Africa Hartebeeshoek94
 Design Criteria
 Reliability Level 2

Consultant:
 Lyners Consulting Engineers

Client:
 ESKOM
 Western Cape Region

CONTRACT
 Swartland Municipality
 Schoonspruit Substation
 132kV Loop In / Out Overhead Line
 Dassenburg - Malmesbury
 TITLE
 LINE PROFILE
 Structure 7 to 13

| REV | DATE | DESCRIPTION | BY | CHKD | APPROVED | SCALE | SHT | DATE | DRG. No. | REV. |
|-----|---------|-----------------------|----|------|----------|-------|--------|---------|------------------|------|
| 01 | 08_2022 | Prelim Design for DRT | RG | TG | CHECKED | TG | 2 | 11_2023 | 52 139 1826 | 01 |
| | | | | | | | 2 OF 6 | | Set 2 Sheet 1 A1 | |

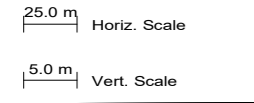
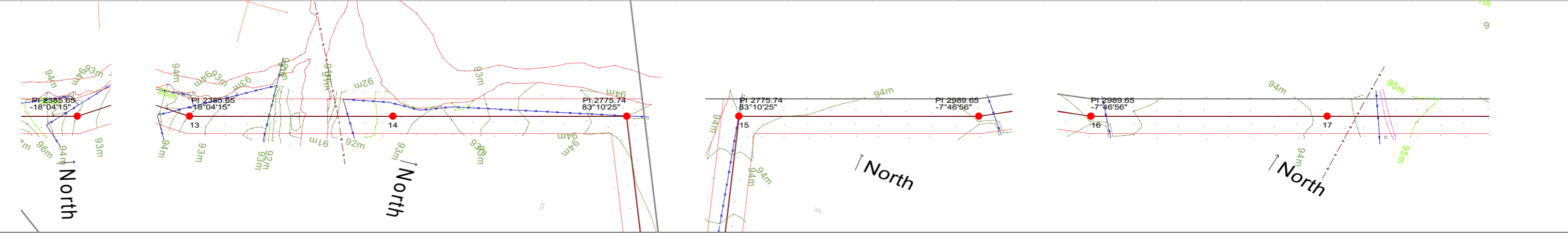
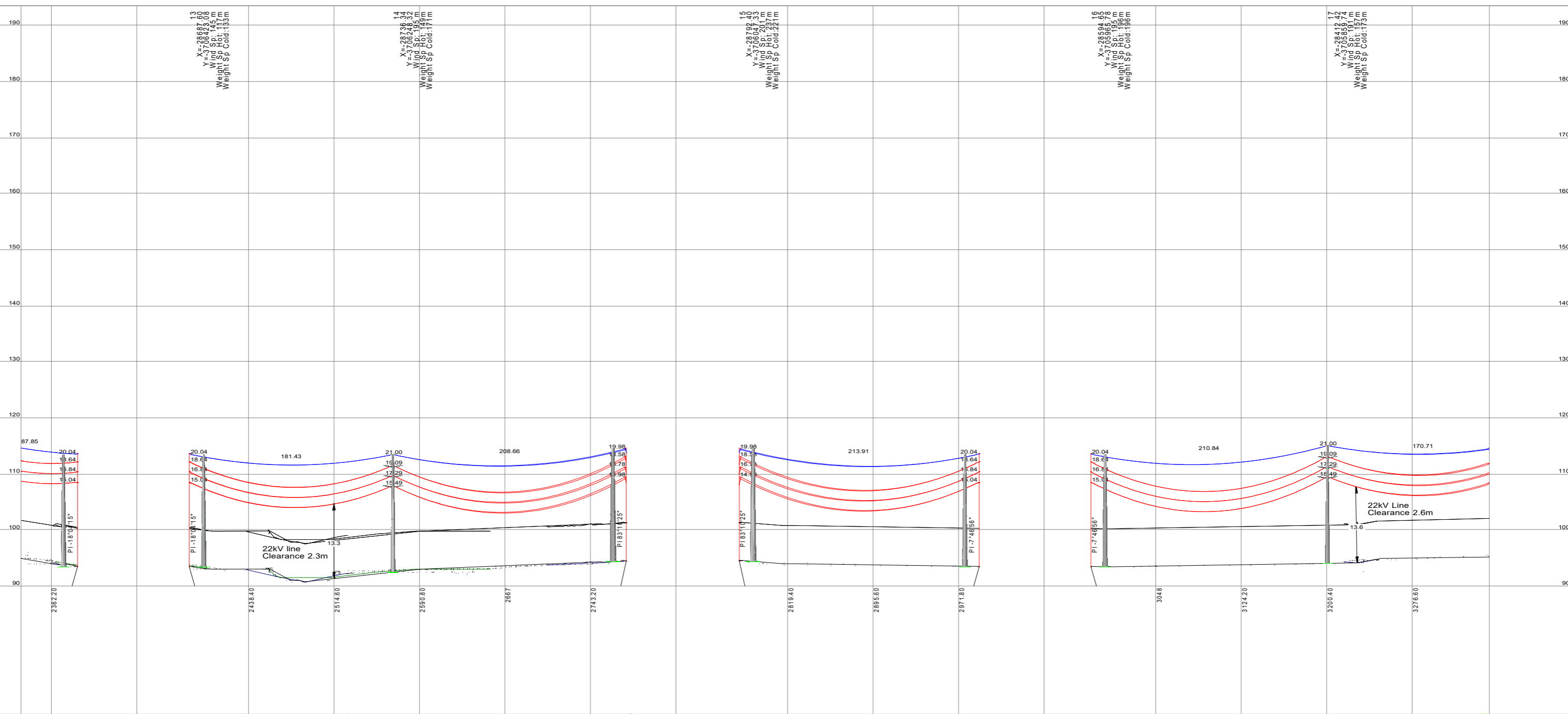

DESIGN CRITERIA

- Min Ground Clearance: 6.3m + 0.5m
- Min Road Clearance: 7.5m
- Min Kingbird Temp: -5 °C
- Max Kingbird Temp: 70°C
- Conductor ACSR Kingbird
- Cond Loading Criteria: C_1800 @ 15°C Final
- OPGW
- OPGW Loading Criteria: 12.0% UTS @ 15°C Final

Co Ordinate System:
WG19: South Africa Hartebeeshoek94

Design Criteria
Reliability Level 2

Consultant:
Lyners Consulting Engineers

Client:
ESKOM
Western Cape Region

CONTRACT
**Swartland Municipality
Schoonspruit Substation
132kV Loop In / Out Overhead Line
Dassenburg - Malmesbury**

TITLE
LINE PROFILE
Structure 13 to 17

| REV | DATE | DESCRIPTION | BY | CHKD | APPROVED | DRAWN | RG | DATE | 11_2023 | DRG. No. | REV. |
|-----|---------|-----------------------|----|------|----------|-------|-------|------------|---------|------------------|------|
| 01 | 08_2022 | Prelim Design for DRT | RG | TG | CHECKED | TG | SCALE | See Scales | | 52 139 1826 | 01 |
| | | | | | | | SHT | 3 OF 6 | | Set 2 Sheet 1 A1 | |

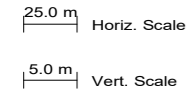
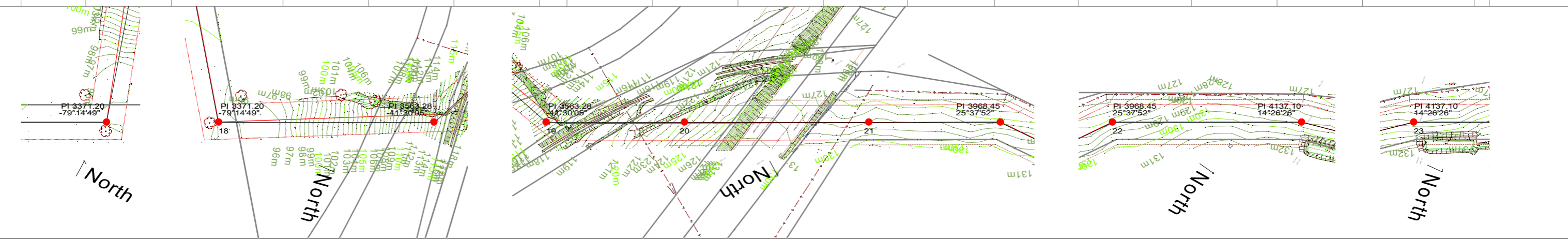
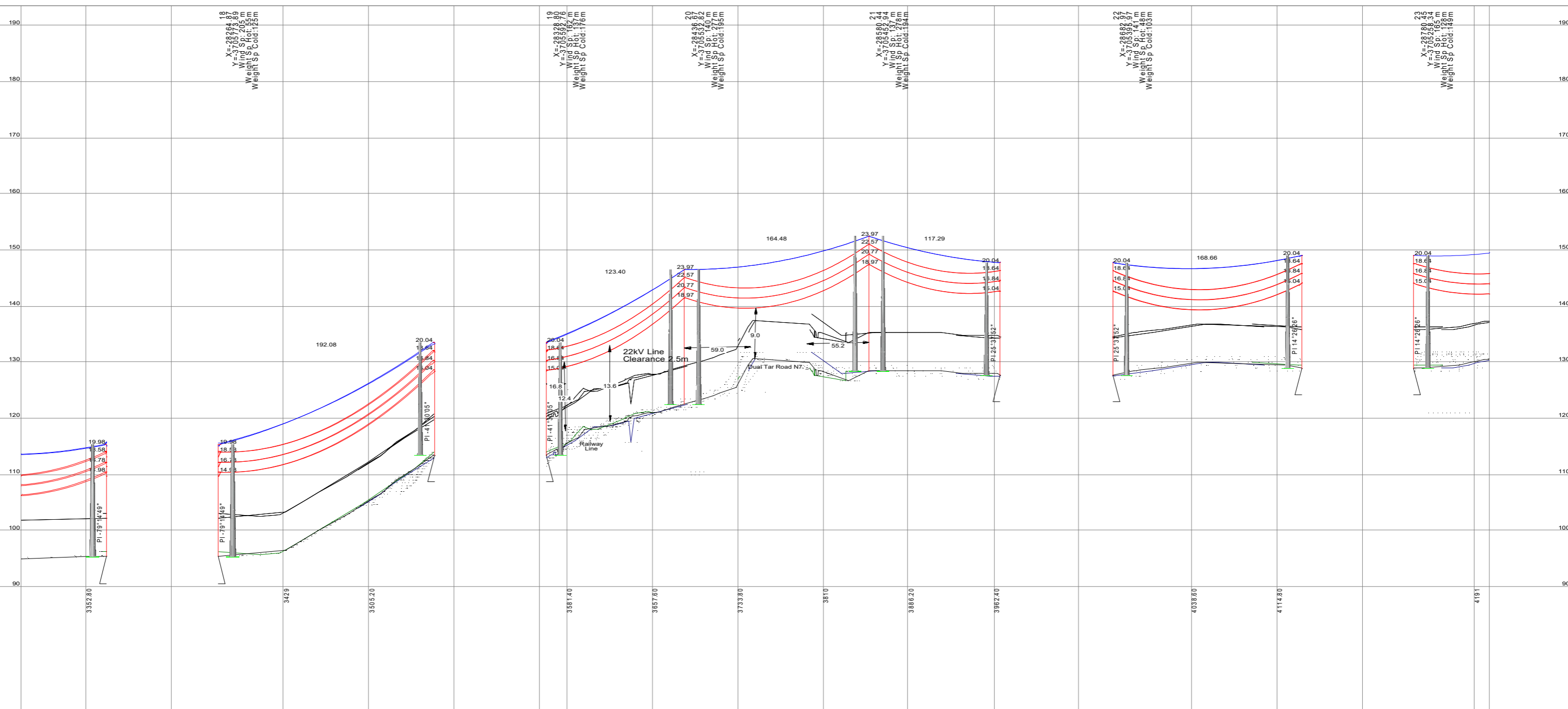

DESIGN CRITERIA
 Min Ground Clearance: 6.3m + 0.5m
 Min Road Clearance: 7.5m
 Min Kingbird Temp: -5 °C
 Max Kingbird Temp: 70°C
 Conductor ACSR Kingbird
 Cond Loading Criteria: C_1800 @ 15°C Final
 OPGW
 OPGW Loading Criteria: 12.0% UTS @ 15°C Final

Co Ordinate System:
 WG19: South Africa Hartebeeshoek94
 Design Criteria
 Reliability Level 2

Consultant:
 Lyners Consulting Engineers

Client:
 ESKOM
 Western Cape Region

CONTRACT
 Swartland Municipality
 Schoonspruit Substation
 132kV Loop In / Out Overhead Line
 Dassenburg - Malmesbury
 TITLE
 LINE PROFILE
 Structure 18 to 23

| REV | DATE | DESCRIPTION | BY | CHKD | APPROVED | SCALE | SHT | DRG. No. | REV. |
|-----|---------|-----------------------|----|------|----------|-------|------------|---------------------------------|------|
| 01 | 08_2022 | Prelim Design for DRT | RG | TG | CHECKED | TG | See Scales | 52 139 1826 Set 2 Sheet 1 A1 | 01 |
| | | | | | | | 4 OF 6 | | |

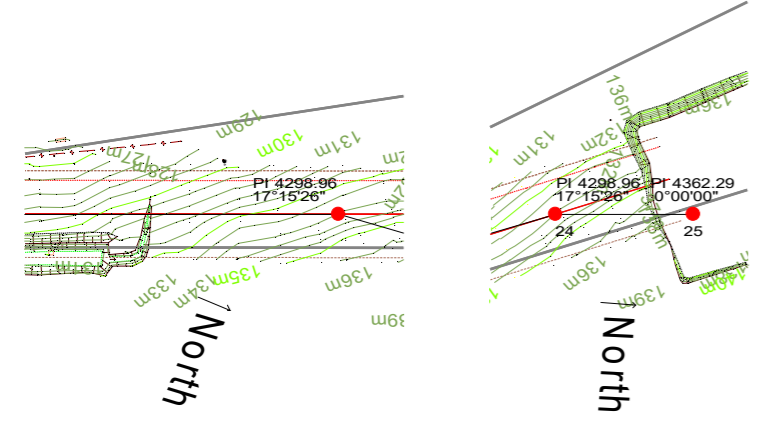
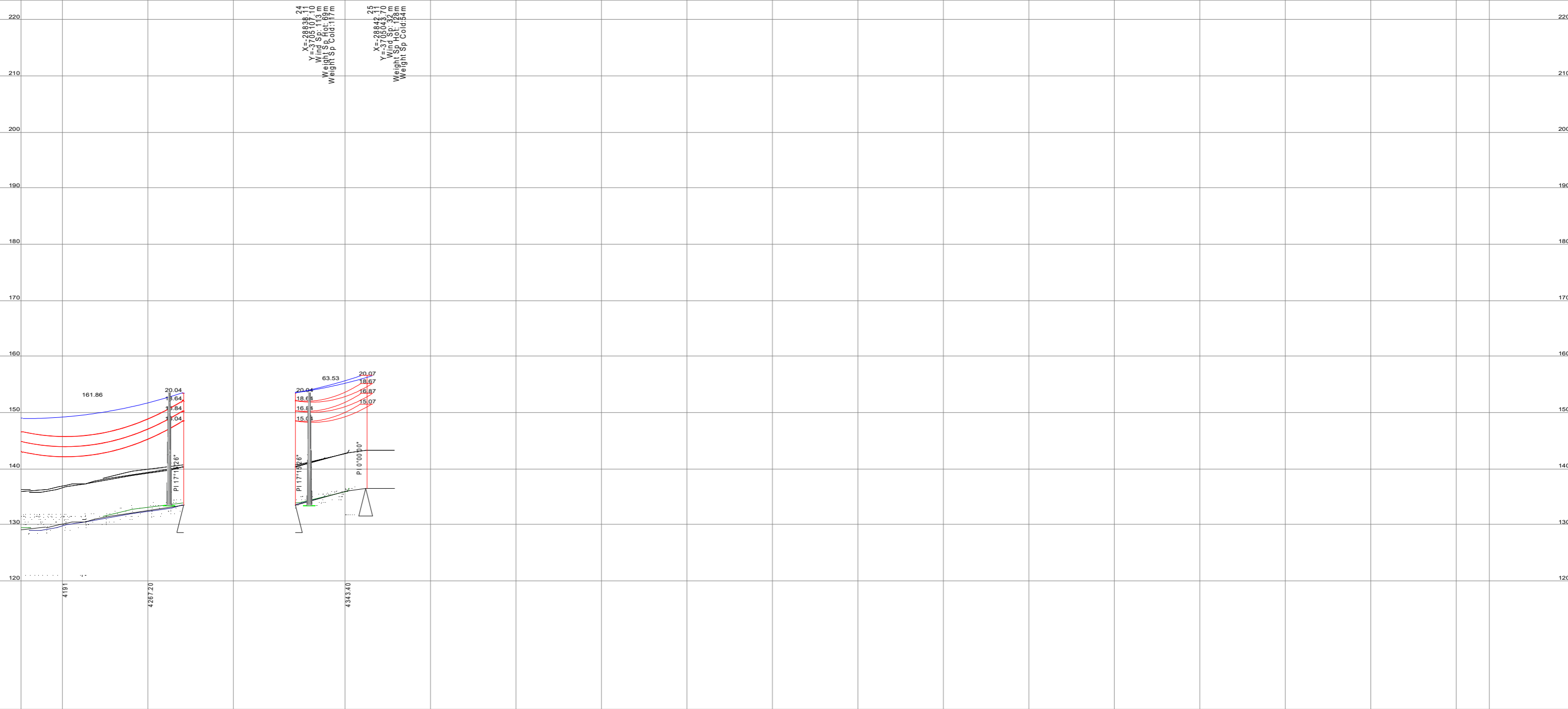

25.0 m Horiz. Scale
5.0 m Vert. Scale

DESIGN CRITERIA
 Min Ground Clearance: 6.3m + 0.5m
 Min Road Clearance: 7.5m
 Min Kingbird Temp: -5 °C
 Max Kingbird Temp: 70°C
 Conductor ACSR Kingbird
 Cond Loading Criteria: C_1800 @ 15°C Final
 OPGW
 OPGW Loading Criteria: 12.0% UTS @ 15°C Final

Co Ordinate System:
 WG19: South Africa Hartebeeshoek94

Design Criteria
 Reliability Level 2

Consultant:
 Lyners Consulting Engineers

Client:
 ESKOM
 Western Cape Region

CONTRACT
 Swartland Municipality
 Schoonspruit Substation
 132kV Loop In / Out Overhead Line
 Dassenburg - Malmesbury

TITLE
 LINE PROFILE
 Structure 24 to 25

| REV | DATE | DESCRIPTION | BY | CHKD | APPROVED | SHT | SCALE | DATE | DRG. No. | REV. |
|-----|---------|-----------------------|----|------|----------|-----|------------|---------|------------------|------|
| 01 | 08_2022 | Prelim Design for DRT | RG | TG | CHECKED | TG | See Scales | 11_2023 | 52 139 1826 | 01 |
| | | | | | | | 5 OF 6 | | Set 2 Sheet 1 A1 | |

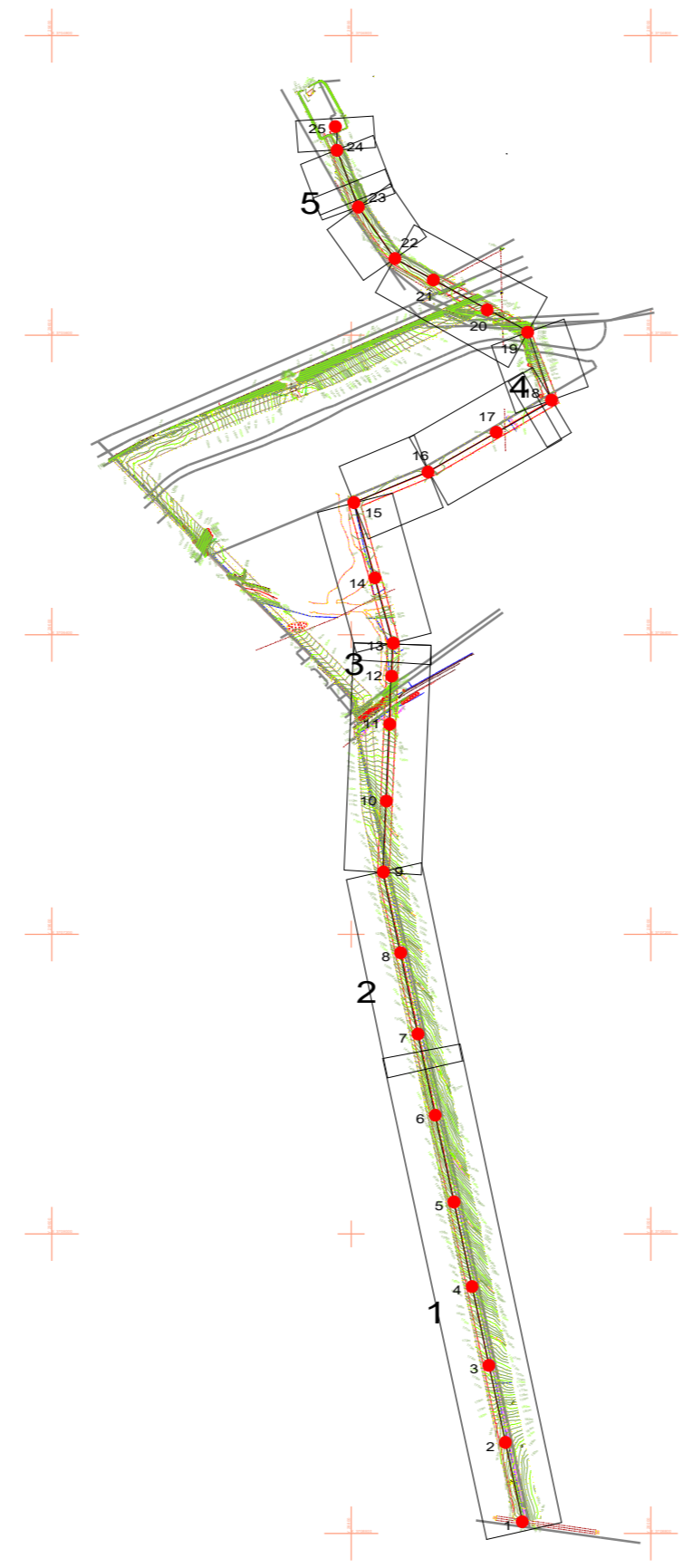

DESIGN CRITERIA
 Min Ground Clearance: 6.3m + 0.5m
 Min Road Clearance: 7.5m
 Min Kingbird Temp: -5 °C
 Max Kingbird Temp: 70°C
 Conductor ACSR Kingbird
 Cond Loading Criteria: C_1800 @ 15°C Final
 OPGW
 OPGW Loading Criteria: 12.0% UTS @ 15°C Final

Co Ordinate System:
 WG19: South Africa Hartebeeshoek94
 Design Criteria
 Reliability Level 2

Consultant:
 Lyners Consulting Engineers

Client:
 ESKOM
 Western Cape Region

| | | | | | |
|----------|------|---|------------|------------------|-------------|
| CONTRACT | | Swartland Municipality Schoonspruit Substation 132kV Loop In / Out Overhead Line Dassenburg - Malmesbury | | | |
| TITLE | | LINE PROFILE Structure to | | | |
| DRAWN | RG | DATE | 11_2023 | DRG. No. | 52 139 1826 |
| CHECKED | TG | SCALE | See Scales | Set 2 Sheet 1 A1 | 01 |
| REV | DATE | DESCRIPTION | BY | CHKD | APPROVED |
| | | | | | |
| | | | | | |

Schoonspruit 132kV LILO Overhead Lines Staking Table R1

| Structure Number | Station (m) | X Easting (m) | Y Northing (m) | Centerline Z Elevation (m) | Ahead Span (m) | Line Angle (deg) | Structure Name | Structure Description | Struct. Height (m) |
|------------------|-------------|---------------|----------------|----------------------------|----------------|------------------|---|-----------------------|--------------------|
| 1 | 0.1 | -28342.8 | -3708768.8 | 184.3 | 216.32 | | 2 off - 20m- Terminal Pole -self suppoting-base mounted | 7615 | 20.1 |
| 2 | 216.4 | -28388.1 | -3708557.3 | 183.2 | 210.20 | | 2 off -20m- Inline -self suppoting-base mounted | 7612 | 20.1 |
| 3 | 426.6 | -28432.1 | -3708351.7 | 173.8 | 215.68 | | 22m- 37kN Pole Susp DC | 7615 | 19.2 |
| 4 | 642.3 | -28477.2 | -3708140.8 | 163.9 | 230.64 | | 22m- 37kN Pole Susp DC | 7615 | 19.2 |
| 5 | 872.9 | -28525.5 | -3707915.3 | 152.4 | 237.30 | | 22m- 37kN Pole Susp DC | 7612 | 19.2 |
| 6 | 1110.2 | -28575.2 | -3707683.2 | 143.9 | 221.59 | | 22m- 37kN Pole Susp DC | 7615 | 19.2 |
| 7 | 1331.8 | -28621.5 | -3707466.6 | 137.3 | 221.59 | | 22m- 37kN Pole Susp DC | 7612 | 19.2 |
| 8 | 1553.4 | -28667.9 | -3707249.9 | 129.0 | 220.83 | | 22m- 37kN Pole Susp DC | 7612 | 19.2 |
| 9 | 1774.2 | -28714.1 | -3707033.9 | 118.0 | 189.48 | 14.57 | 2off - 20m- 0-45 Angle -self suppoting-base mounted | 7612 | 20.0 |
| 10 | 1963.7 | -28705.9 | -3706844.6 | 109.1 | 205.65 | | 22m- 37kN Pole Susp DC | 7615 | 19.2 |
| 11 | 2169.3 | -28697.0 | -3706639.2 | 101.9 | 128.47 | | 22m- 37kN Pole Susp DC | 7612 | 19.2 |
| 12 | 2297.8 | -28691.4 | -3706510.8 | 96.1 | 87.85 | | 23m- 37kN Pole Susp DC | 7615 | 20.1 |
| 13 | 2385.7 | -28687.6 | -3706423.1 | 93.5 | 181.43 | -18.07 | 2off - 20m- 0-45 Angle -self suppoting-base mounted | 7612 | 20.0 |
| 14 | 2567.1 | -28736.3 | -3706248.3 | 92.5 | 208.66 | | 24m- 37kN Pole Susp DC | 7615 | 21.0 |
| 15 | 2775.7 | -28792.4 | -3706047.3 | 94.5 | 213.91 | 83.17 | 2off - 20m- 90deg Angle -self suppoting-base mounted | 7612 | 20.0 |
| 16 | 2989.7 | -28594.7 | -3705965.8 | 93.5 | 210.84 | -7.78 | 2off - 20m- 0-45 Angle -self suppoting-base mounted | 7615 | 20.0 |
| 17 | 3200.5 | -28412.4 | -3705859.7 | 94.1 | 170.71 | | 24m- 37kN Pole Susp DC | 7612 | 21.0 |
| 18 | 3371.2 | -28264.9 | -3705773.9 | 95.4 | 202.39 | -81.30 | 2off - 20m- 90deg Angle -self suppoting-base mounted | 7612 | 20.0 |
| 19 | 3573.6 | -28339.0 | -3705585.6 | 114.5 | 119.62 | -39.64 | 2off - 20m- 0-45 Angle -self suppoting-base mounted | 7612 | 20.0 |
| 20 | 3693.2 | -28443.8 | -3705527.8 | 123.2 | 159.43 | | 2 off -24m- Inline -self suppoting-base mounted | 7615 | 24.0 |
| 21 | 3852.6 | -28583.4 | -3705450.9 | 128.5 | 113.70 | | 2 off -24m- Inline -self suppoting-base mounted | 7612 | 24.0 |
| 22 | 3966.3 | -28683.0 | -3705396.0 | 127.7 | 168.66 | 25.82 | 2off - 20m- 0-45 Angle -self suppoting-base mounted | 7615 | 20.0 |
| 23 | 4135.0 | -28780.4 | -3705258.3 | 129.0 | 161.86 | 14.44 | 2off - 20m- 0-45 Angle -self suppoting-base mounted | 7612 | 20.0 |
| 24 | 4296.8 | -28838.1 | -3705107.1 | 133.5 | 63.53 | 17.26 | 2off - 20m- 0-45 Angle -self suppoting-base mounted | 7612 | 20.0 |
| 25 | 4360.4 | -28842.1 | -3705043.7 | 136.5 | | | 2 off - 20m- Terminal Pole -self suppoting-base mounted | 7612 | 20.1 |